

NORTH PENNSYLVANIA RAILROAD.

SPRINGFIELD TWP., BUCKS CO., PA.  
AND  
UPPER SAUCON TWP., LEHIGH CO., PA.

ROBERT D. SAMES  
NOW  
GEORGE L. HENN

Sept 5/79  
Sht. 7 1/4 39760±  
To  
Sht. 4 1/2 2395170±

SCALE: 1" = 50'

MICHAEL SHAEFER

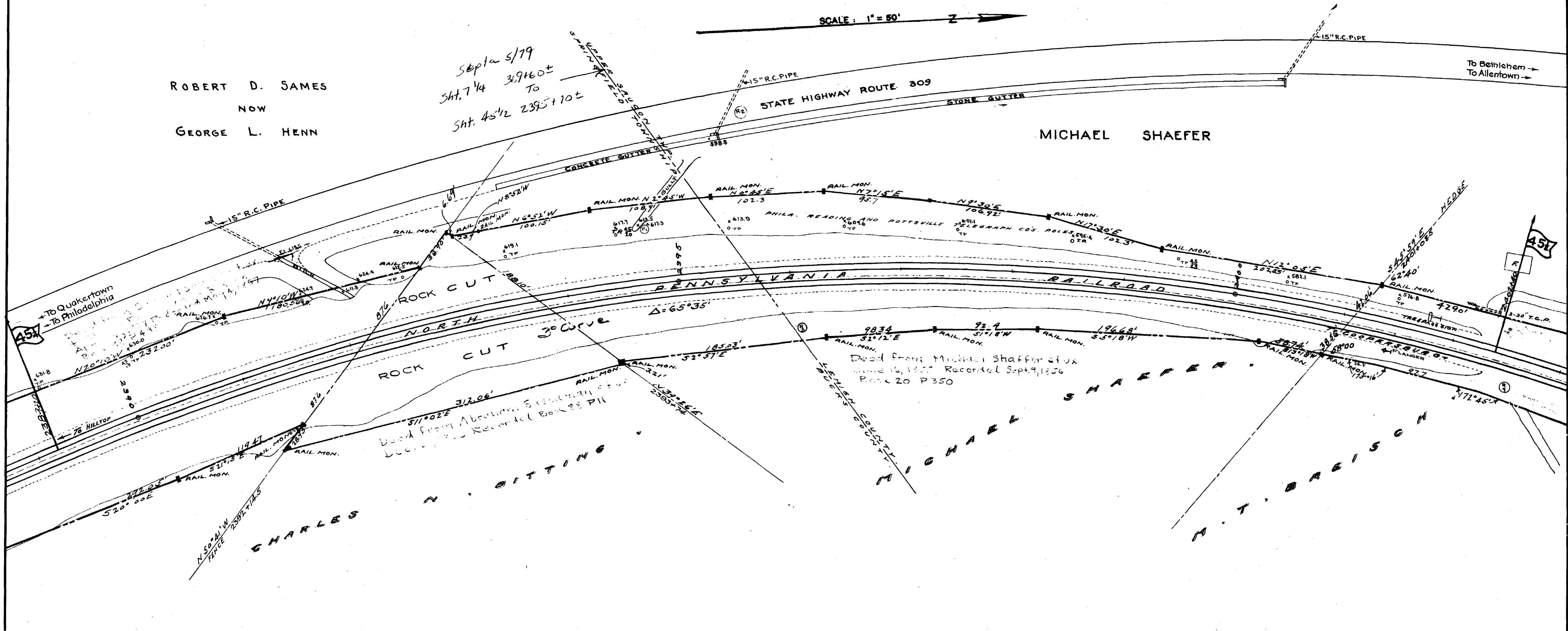

Ⓐ	Crossing Abandoned	4-23-56	D.E.J.	A.N.J. Grade biry Rep. 1955	-
Ⓑ	Pole Line Removed, Map checked	6-17-53	L.M.M.		
Ⓒ	State Highway Route 309 added	7-10-36	R.C.R.	924	
Ⓓ	Poles Revised	12-30-35	R.C.R.		
No.	REVISION OF TRACING	DATE OF REVISION	REVISED BY	NOTE BOOK	DATE OF CHECKING

VS 811K LC0301 MP 45.1 - 45.5

SEPTEMBER 1916