

Scale 1"=50'

GEORGE L. HENN

FORMERLY

ROBERT D. SAMES

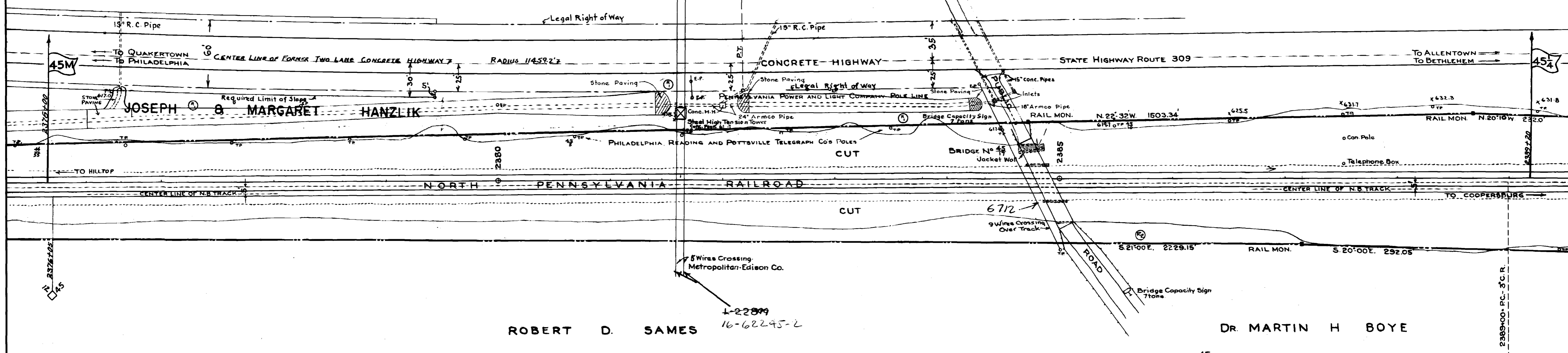

ROBERT D. SAMES

1-22899
16-62295-2

NOW

GEORGE L. HENN

DR. MARTIN H. BOYE

BRIDGE NO. 45

- Substructure** — Foundations, Abutments and Piers; Stone Masonry
70' between Abutments. Angle 64°
- Superstructure** — Wooden Stringers, 3 Spans Carrying Public Road.
Top of rail to floor of bridge 22.2'
Clearance 20.5'

①	Pole Line Removed, Map Checked	8-19-53	L. M.		
②	Ditch & Drainage Facilities Added	9-13-51	G. G. W.	P-9291	4-6-51
NO	REVISION OF TRACING			REVISED BY NOTE BOOK	DATE OF CHANGE

July 1936

V.S. 8118 L.C. 0201 M-45.0-45.2