

SPRINGFIELD TWP.  
BUCKS CO., PA.

NORTH PENNSYLVANIA RAILROAD.

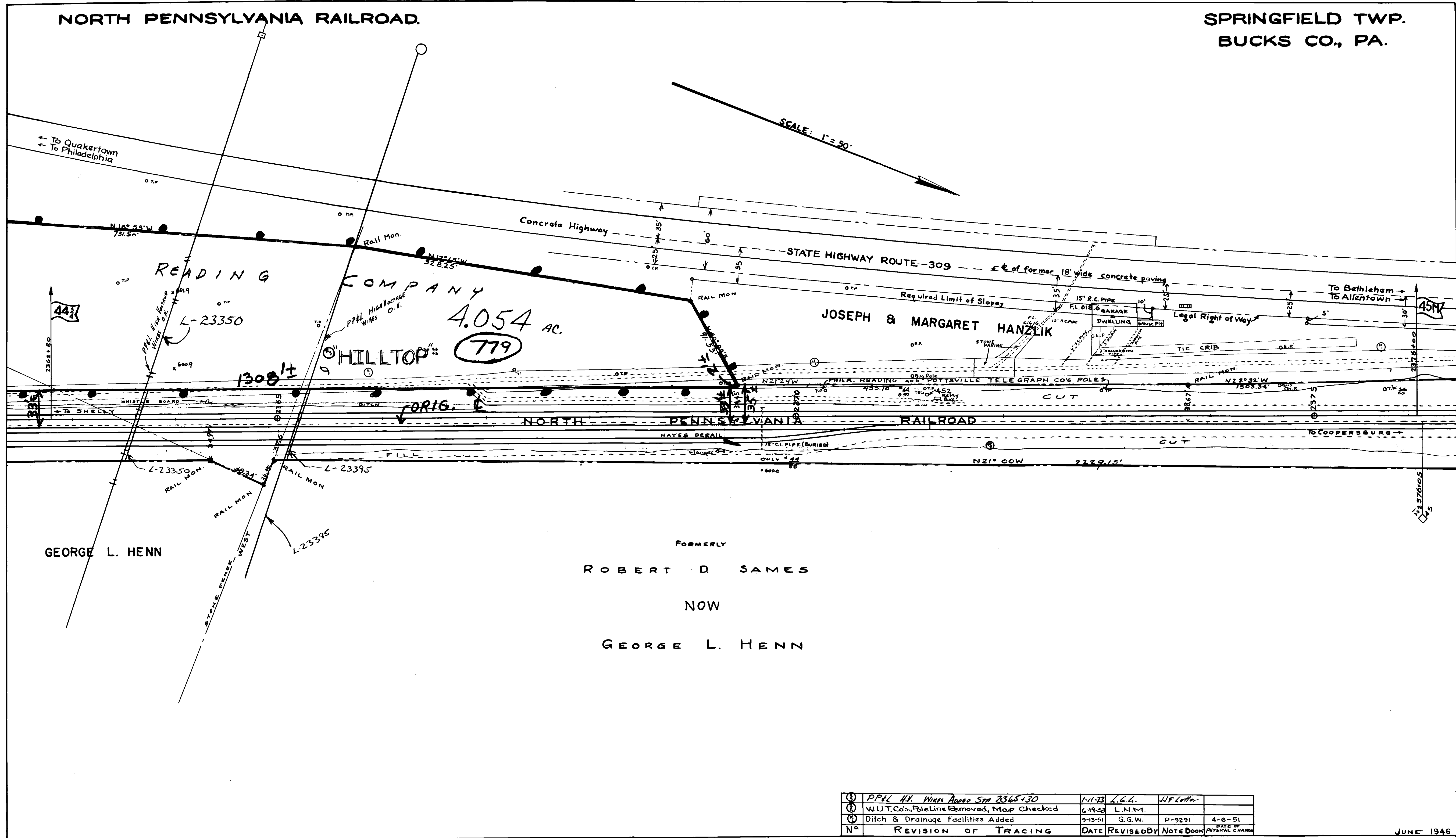

GEORGE L. HENN

FORMERLY  
ROBERT D. SAMES  
  
NOW  
GEORGE L. HENN

①	PP&L H.V. Wires Added Sta 2345+30	1-11-23	L.G.H.	J.F. Letter	
②	W.U.T. Co's. Pble Line Removed, Map Checked	6-19-50	L.N.M.		
③	Ditch & Drainage Facilities Added	9-13-51	G.G.W.	P-9291	4-6-51
Nº	REVISION OF TRACING	DATE	REVISED BY	NOTE BOOK	DATE OF PHYSICAL CHANGE

JUNE 1946

AS 8.11 20.001 MF 44.7-45.0